

NOMENCLATURE	
V-1	TOP FILL CHECK VALVE
V-2	LIQUID VALVE
V-4	VENT/FULL TRYCOCK VALVE
V-5	ISOLATION VALVE
V-6	5-WAY VALVE
V-7	PRESS. BLDG FEED CHECK VALVE
V-8	PRESS BLDG RTN CHECK VALVE
V-9	GAS USE VALVE
V-10	ECONOMIZER CHECK VALVE
LI-1	LEVEL INDICATOR, CYL-TEL
PI-1	PRESSURE INDICATOR
R-1	REGULATOR PBE-1
RV-1	MAIN RELIEF VALVE
RV-2	LINE RELIEF VALVE
BD-1	BURST DISC
S-1	STRAINER

PIPING	
A	TOP FILL
B	LIQUID WITHDRAWAL
C	PRESSURE BUILDING INLET
D	PRESSURE BUILDING OUTLET
E	LIQUID PHASE
F	VAPOR PHASE
G	VENT/FULL TRYCOCK
H	SAFETY CIRCUIT
J	ECONOMIZER CIRCUIT

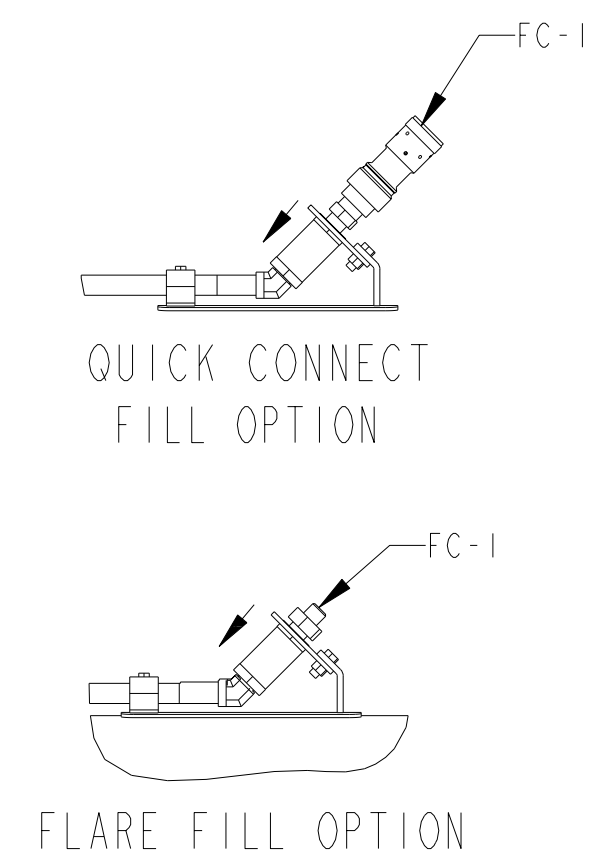

DESIGN SPECIFICATION		
ITEM	INNER VESSEL	OUTER JACKET
CODE	ASME SEC. VIII, DIV I	CGA 341-1995
RELIEF SETTING MAWP	500 PSI / 35.45 bar	
GROSS VOLUME	568 GALLONS / 2149 LITERS	
NET VOLUME	516 GALLONS / 1954 LITERS	
TARE WEIGHT	3600 lbs / 1630 kgf	
NORMAL EVAPORATION RATE	1% PER DAY NITROGEN .62% PER DAY ARGON & OXYGEN	
MATERIAL	9% NICKEL	TYPE 304 STAINLESS STEEL
	PALLET BASE ZINC COATED CS A36	
FULL WEIGHT		
LIQUID OXYGEN	8600 lbs / 3900 kg	
LIQUID NITROGEN	7100 lbs / 3220 kg	
LIQUID ARGON	9600 lbs / 4350 kg	
GASEOUS EQUIVALENT AT 1 ATM AND 70°F / 1 ATM AND 0°C		
OXYGEN	59,400 SCF / 1570 Nm <sup>3</sup>	
NITROGEN	48,100 SCF / 1270 Nm <sup>3</sup>	
ARGON	58,100 SCF / 1530 Nm <sup>3</sup>	
GAS DELIVERY RATE 2000 SCFH / 52.4 Nm <sup>3</sup> H		

REV	ECR NO	REVISION DESCRIPTION	BY	DATE	APPROVED	DATE	SCALE	TITLE	DRAWING NO.	REV
A		UPDATED DESING SPEC	CMV	6-26-06	CMV	6-9-05	N/A	OUTLINE AND DIMENSION	D-12993020	A
					TJS	6-14-05		PERMA-CYL 2000 09		
					KJR	6-10-05				
					CJS	6-13-05				
					RC	6-10-05				
					RDF	6-15-05				

THE MATERIALS AND INFORMATION, INCLUDING THE PRINCIPLES OF DESIGN CONTAINED IN THIS PRINT, IS THE EXCLUSIVE PROPERTY OF CHART, INC., AND IS CONFIDENTIAL AND PROPRIETARY INFORMATION. THIS INFORMATION MAY NOT BE REPRODUCED, COPIED, OR LOANED, IN PART OR IN WHOLE, NOR IS THE INFORMATION TO BE RELATED TO ANY PARTY WITHOUT CHART'S PRIOR WRITTEN CONSENT.

UNLESS OTHERWISE SPECIFIED DIMENSIONS ARE IN INCHES.  
 TOLERANCES:  
 FRACTIONS ± 1/8  
 ANGLES ± 1°  
 2 PLACE DECIMALS ± .01  
 3 PLACE DECIMALS ± .001

PART NUMBER  
**12993020**

DRAWING NO. **D-12993020** REV **A**  
 SCALE N/A DO NOT SCALE DRAWING SHEET 1 OF 1